

PROPOSED PLAN OF SUBDIVISION OF  
 LOT A, DL 143, ODYD, PLAN 17786, EXCEPT PLAN KAP65770,  
 AND LOT 1, DL 143, ODYD, PLAN EPP105911.

BCGS 82E.093  
 SCALE 1:750 METRIC

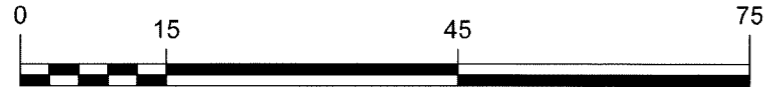

The intended plot size of this plan is 432mm in width by 280mm in height (B-size) when plotted at a scale of 1:750 METRIC.

LOT A PID: 006-122-191  
 LOT 1 PID: 031-409-253  
 CIVIC ADDRESS: 854-860 & 910 McCURDY RD,  
 CLIENT: CALLAHAN PROPERTY GROUP

This document shows the relative location of improvement(s) named above with respect to the boundaries of the described parcel.

This document was prepared for the exclusive use of the client named herein.

Lot dimensions shown are derived from field survey measurements and may vary from Land Title Office records.

This document shall not be used to define property lines or corners.

Scale 1:750 Metric.  
 Distances shown are in metres and decimals thereof.

Notes:  
 - Unregistered interests have not been included or considered.  
 - A comprehensive legal survey may reveal offsets to boundaries that differ from those shown.

Charges on Title Rem Lot A, Plan 17786:  
 - none

Charges on Title Lot 1, Plan EPP105911:  
 - Statutory Rights of Way LB51848, CA7876581.  
 - Lease LB148407, LB495603

**DRAFT**

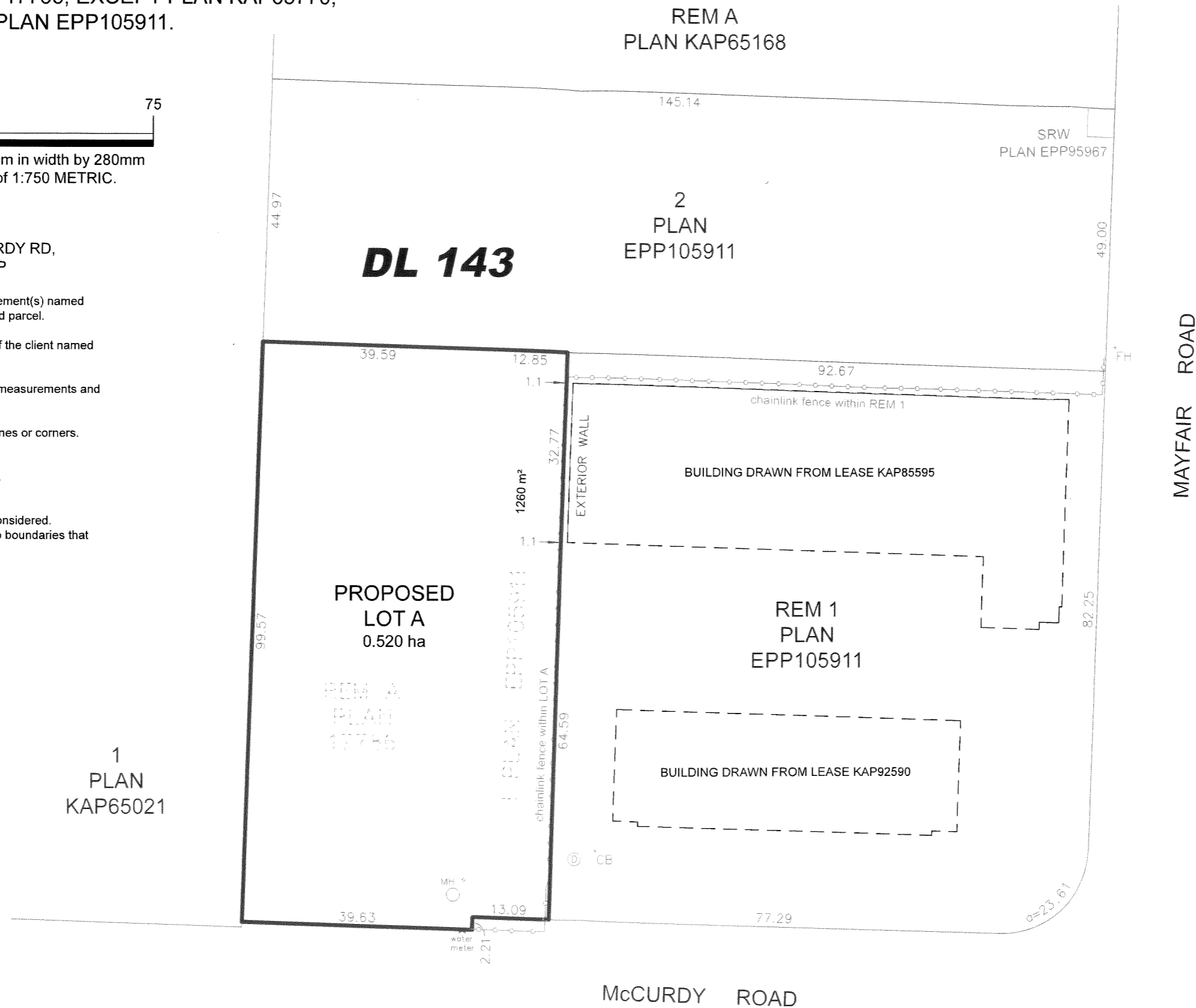

**DA Goddard Surveys**  
 1315 St. Paul Street, Kelowna BC  
 File: 423007-SD September 6, 2023